



# PS4 Series

MKT-E-15060F

## Busbar Plug-in Connector Supporting 150 Amps/300 Amps with Floating Capability

### ◆ Features

1. Plug-in connection to improve efficiency and safety of assembly, maintenance, and unit expansion works
2. Floating structure to absorb mounting misalignment  $\pm 2\text{mm}$  in XY direction
3. High current support:  
150 Amps (supported busbar thickness 3mm or 0.125 inch (3.175mm))  
300 Amps (supported busbar thickness 6mm or 0.25 inch (6.35mm))
4. Compact design applicable to 1U size
5. Multiple contact points on power contact decrease heat generation by current flow
6. Safety design in consideration of deterioration of resin over time
7. Large effective mating length reserves sufficient design margin of a unit
8. UL/C-UL/TÜV pending

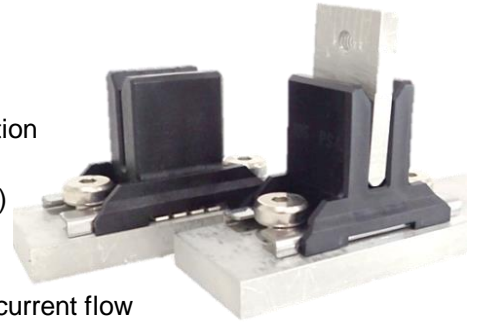

### ◆ Easy and Optimized Assembly with Plug-in Connection

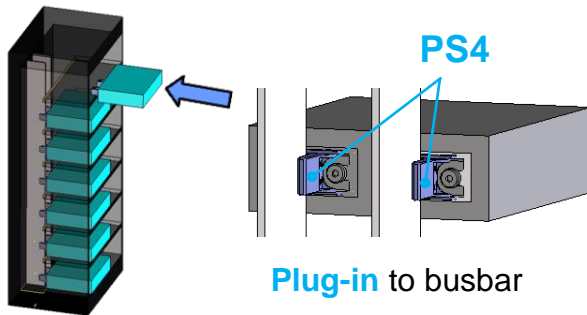

#### <Connector's benefits against screw-tightening>

##### Workload (assembly, maintenance, expansion)

- Plug-in mating largely **reduces working hours**. ★
- **Highly reliable connection** is ensured regardless of operator's skill ★

##### Safety

- Operator does not need to touch the conductor, which **improves safety**. ★

### ◆ Dimensions

#### <Vertical connection type>

Product Name:

- PS4-3.175T
- PS4-6.35T

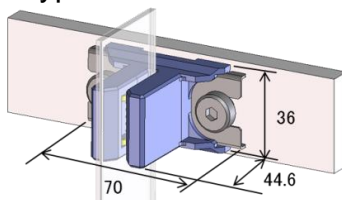

#### <Horizontal connection type>

Product Name:

- PS4A-3.175T
- PS4A-6.35T

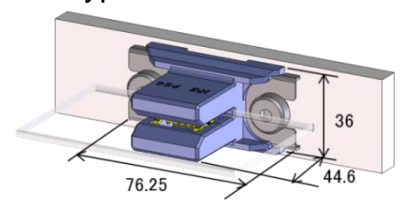

### ◆ Connector floats to the most appropriate mating position where it aligns with busbar.

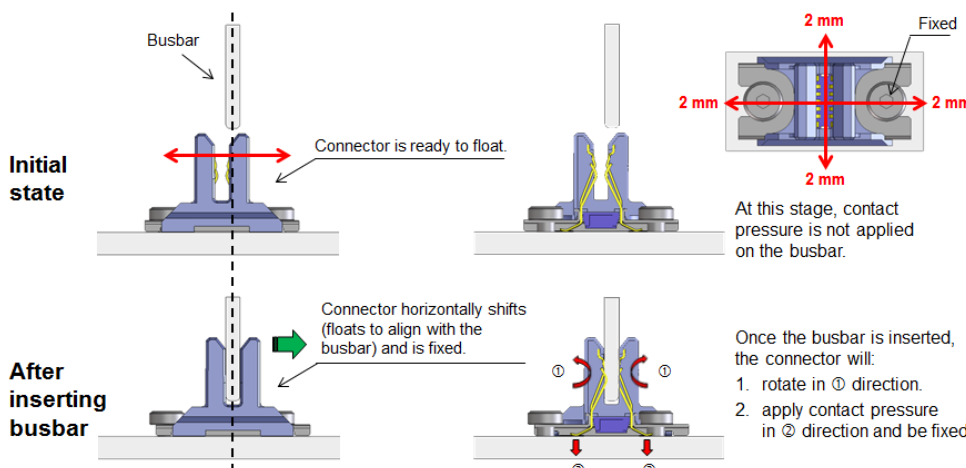

Floating amount:  
 $\pm 2\text{mm}$  in XY direction

### ◆ Material & Finish

COMPONENT	MATERIAL	FINISH, REMARKS
Housing	PBT	UL94V-0, Black
Metal Plate	Stainless steel	—
Contact	Copper alloy	Silver plating
Stopper	PBT	UL94V-0, Black
Shoulder Bolt	Steel	Nickel plating

Specifications herein are subject to change without notice. Contact Hirose for latest specifications, drawings or availabilities.